

2010

500'

500'

YOUNG DOC. NO. 400326

BUFFER ZONE

EXISTING BUILDING 390' ± FROM
NEAREST EXISTING TUNNEL

EXISTING BUILDING 600' ± FROM
NEAREST EXISTING ACTIVE TUNNEL

EXISTING BUILDING 150' ± FROM
NEAREST EXISTING ACTIVE TUNNEL

DERRICK
SCREEN

EXISTING BUILDING
200' ± FROM NEAREST
EXISTING TUNNEL

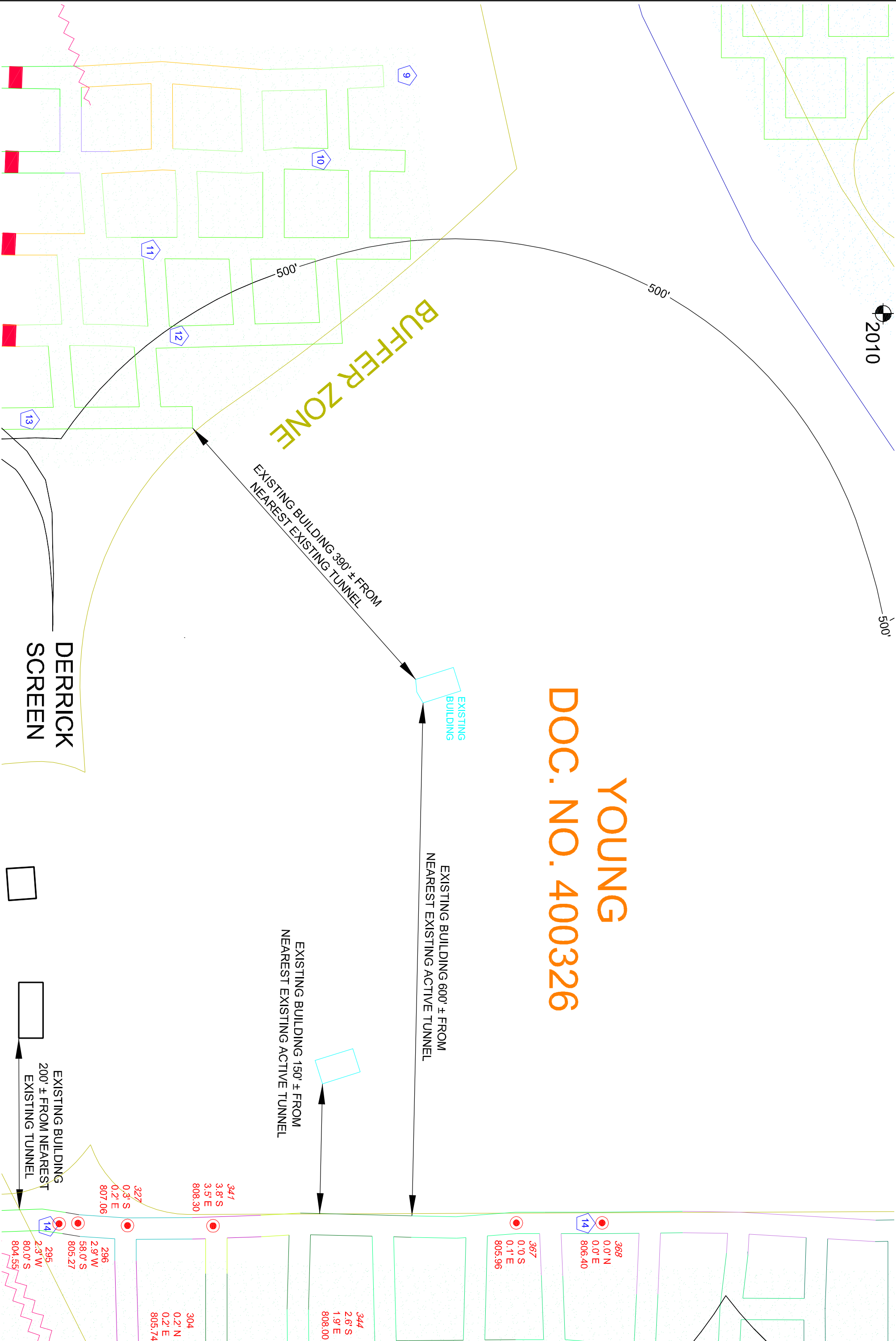

341 3.8' S 3.5' E 808.30

344 2.6' S 1.9' E 808.00

367 0.0' S 0.1' E 805.96

368 0.0' N 0.0' E 806.40

304 0.2' N 0.2' E 805.74

296 2.9' W 58.0' S 805.27

295 2.3' W 80.0' S 804.55

327 0.3' S 0.2' E 807.06

PROJECT NO.	CAD FILE	SURVEYED BY	DRAWN BY	APPROVED BY	NO.	DATE	REVISIONS	BY
18-0602	18-0602.dwg	TMH	TMH					
9/7/2018	18-0602.crd	9/5/2018	TMH	1"=100'				

WISCONSIN INDUSTRIAL SAND COMPANY, LLC
A DIVISION OF COVIA HOLDINGS CORP.
MAIDEN ROCK, WISCONSIN
CONTROL POINT DETAIL MAP

Healy Land Surveying
P.O. Box 221
Niagara, WI 54151
Phone: 715-548-0566
info@healysurveying.com

J-9F
SHEET NO.