

**BUFFER ZONE**

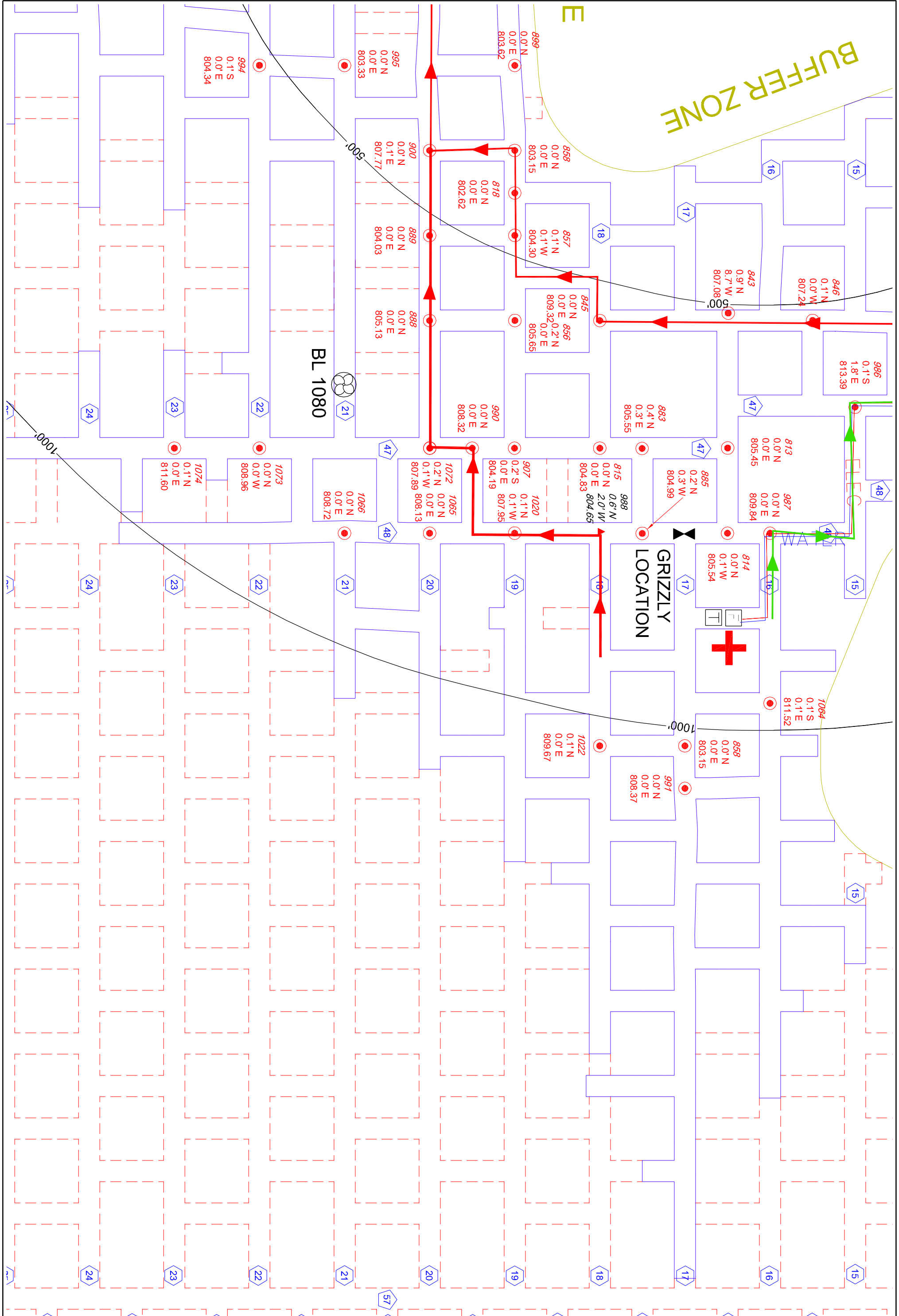

**BL 1080**

**GRIZZLY LOCATION**



PROJECT NO. 19-0639	CAD FILE 19-0639.dwg	SURVEYED BY TMH	DRAWN BY TMH	APPROVED BY	NO.	DATE	REVISIONS	BY
DATE 5/2/2019	CRD FILE 19-0639.crd	SURVEY DATE 4/30/2019	CHECKED BY TMH	SCALE 1"=100'				

WISCONSIN INDUSTRIAL SAND COMPANY, LLC  
 A DIVISION OF COVIA HOLDINGS CORP.  
 MAIDEN ROCK, WISCONSIN  
 CONTROL POINT DETAIL MAP

**HEALY**  
 LAND SURVEYING

Healy Land Surveying  
 P.O. Box 221  
 Niagara, WI 54151  
 Phone: 715-548-0566  
 info@healysurveying.com

J-71  
 SHEET NO.