

SURVEYOR'S NOTE:

According to recorded deeds, Document Nos. 1261987 and 1320121, the Town of Dunn appears to be the owner of Bass Circle, Trout Trail, Perch Court, Northern Court, Norman Drive and Charles Lane. The record descriptions are vaguely written, appear to have typographical errors and do not fit the as-built roadways as shown hereon.

According to an unrecorded affidavit from Donn E. Barber, Shareholder of Bay View Heights, Inc., dated December 30, 2021, the Town of Dunn owns Pike Lane, Charles Lane from Pike Lane to US Highway 51 and Norman Drive from Charles Lane to US Highway 51, as well as the unnamed road extending east from the southwesterly terminus of Norman Drive. The affidavit also states that the remaining roads are privately owned by Bay View Heights, Inc.

DENOTES TYPICAL GAS AND ELECTRIC SERVICE HOOKUPS

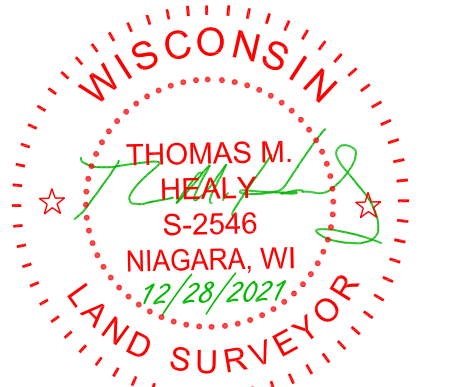

Revised: 1/24/2022

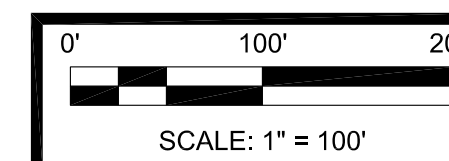
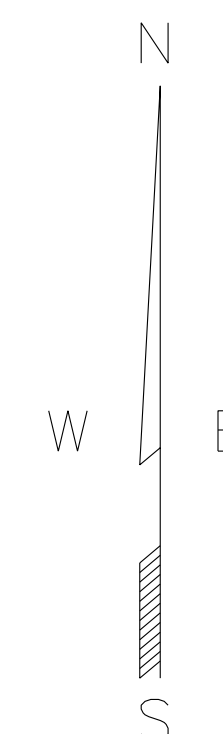

Surveyor's File Name and/or No.: 21-0772
 Surveyor's Reference Project No./Name.: REALM - STOUGHTON, WI
 CAD Operator: TMH

Survey Performed and Drafted By:



Healy Land Surveying
 P.O. Box 221
 Niagara, WI 54151
 Phone: 715-548-0566
 info@healysurveying.com

For Questions & Comments & Updates on this survey please contact
 Info@RealmLandServices.com or call 571-208-2090

REALM PROJECT NAME: Bayview Heights
REALM PROJECT NO.: 0003-21-0155
SITE ADDRESS:
 909 Charles Lane, Stoughton, WI 53589

FOR QUESTIONS & COMMENTS & UPDATES ON THIS SURVEY PLEASE CONTACT:

REALM LAND SERVICES, Inc.
 Info@RealmLandServices.com
 Phone Number: 571-208-2090



SEE SHEET 1 OF 4 FOR BOUNDARY AND TITLE DATA
 SEE SHEET 2 OF 4 FOR SITE IMPROVEMENTS